

# ATELIER PRO

Opdrachtgever  
Gemeente  
Amsterdam

Project type  
architecture

Kosten  
€ 14.400.000,-

Project status  
completed

Locatie  
Vlaardingenlaan  
25  
Amsterdam  
Netherlands

Functies  
education,  
renovation & re-  
use

14.100 m<sup>2</sup>

Periode  
2015 - 2019

Oplevering  
2019



beeld

## Lumion, Amsterdam

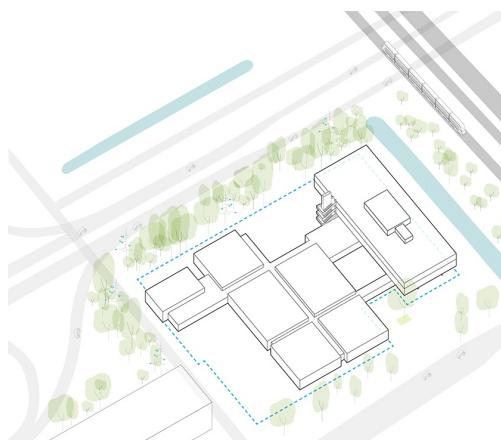

An huge atrium has been created as a central meeting place between the old building and the new building part. Here is the main entrance leading to all school sections. Your eye will be caught by the spectacular spiral staircase that gives access to all clusters.

The junior grade pupils are located in the new, five-layer building section. Each cluster forms a clear, individual space within the school. Its small-scale ensures attention for every student. The monumental facades were respectfully modernized. Single glass is replaced by HR ++double insulation glass and the old wooden window frames have been reused. The concrete has been cleaned, repaired and, where possible, insulated. A different façade material is chosen for the new parts. Inspired by the rhythm of the existing facade, the new building features horizontal bands with a vertical articulation, executed in custom-made profiled aluminum cladding.

The educational vision of Lumion is based on personalized learning. Students each have their own learning path. They determine their own pace and level and choose where and how they learn. So therefore only very few traditional classrooms are found here. Instead, there is a diversity of work- and learning places, specially developed for specific learning activities, depending on individual needs. There are common places for 5, 10, 30, 60 and 90 children in the entire building, with every element in the design well thought out. The interior was also designed by Atelier PRO.

Ontwerpteam  
project architect  
Dorte Kristensen, Martijn de Visser

interieur architect  
Amal Habti

projectleider  
Eelko Bemener, Martijn de Visser

design team  
Allard de Goeij, André van Veen,  
Constanze Knüpling,  
Corine Jongejan, Elena Vezzali,  
Joost Smorenburg, Karho Yeung,  
Lisette Plouvier, Marriet Boutez,  
Raymond Wernet, Ron Bruin,  
Ronald Peters, Tobias Thoen

costs consultant  
John Koks

Projectteam  
landscape designer  
Gemeente Amsterdam

general contractor  
Hegeman, Nijverdal

physics consultant  
LBP Sight

structural engineer  
Van Rossum Raadgevende  
Ingenieurs

The former MTS (secondary technical school) building from 1973 designed by architect B.J. Ingwersen has been transformed by Atelier PRO architects into the new premises of Lumion Amsterdam, a school for senior general and pre-university. A combination of renovation and new construction has given this municipal monument a second life as the accommodation for the first Kunskapsskolan type of education in the Netherlands.

The senior grade pupils are located on the top floors of the existing building. The floors that had been cluttered over the years, have been reopened. Team spaces, consultation rooms and 'wonder rooms' are situated around learning areas. 'Wonder rooms' are rooms that can accommodate 60 to 90 pupils receiving education at the same time, and let themselves be inspired or marveled.

[www.wonderrooms.nl](http://www.wonderrooms.nl) [www.kunskapsskolan.nl](http://www.kunskapsskolan.nl) [www.lumion.nl](http://www.lumion.nl)

# ATELIER PRO

## Awards and nominations

World Architecture News (WAN) 2020 Award  
Nomination World Interior News (WIN) 2020 Award  
Nomination National Steel Prize 2020 in the category  
"characteristic steel building parts"  
Nominated for the ArchDaily 2021 Building of the Year  
Awards

## Publications

CFSA-Winter 2021 NO.07\_p72-81  
Education Snapshots  
Aeccafe January 2021  
Dutch education minister Arie Slob pays visit to  
Lumion Amsterdam  
Lumion Amsterdam nominated for the WAN20  
Award (architecture) and the WIN20 Award  
(interior design)  
Inheritage 2020 p43 'The World's Greatest  
Architecture Projects'  
Archdaily Juni 2020 (Spanish)  
Archdaily March 2020