

Client  
Schouten Bouw tot  
3e kwartaal 2019.  
Daarna is het  
project  
overgenomen door  
Niersman Bouw

Project type  
architecture  
  
Functions  
residential

13,125 m<sup>2</sup>

Project status  
completed

Period  
2015 - 2021

Completion  
2021

Location  
Wijndaelerweg  
Den Haag  
Netherlands



image

## Housing complex ZuiderDuinen, The Hague

ZuiderDuinen is a housing complex in the Hague, located between the city and the dunes, surrounded by greenery. The complex is located next to the International School The Hague (ISH), at the corner of Ockenburgstraat and Wijndaelerweg. As the architect of the ISH, Atelier PRO was already very familiar with the area, which meant we found it straightforward to integrate the project in its surroundings.

The complex consists of 61 spacious owner-occupied and rental apartments, with a nursery and after-school-daycare on ground floor level. To preserve the open character of the area, we clustered the apartments in three separate residential blocks. The car park is kept out of sight, because it is incorporated in an artificial dune, which also houses the main entrances, storage rooms and technical facilities of the residential blocks. On the Wijndaelerweg, the 'dune' has an urban character, with shop windows; towards the dunes, it is visually connected to the surrounding landscape by means of a green 'slope'. The nursery and after-school-daycare both face the International School. The top of the 'dune' was designed as a green deck.

Design team  
project architect  
Alex Letteboer, Antony Laurijsen,  
Martijn de Visser

project leader  
Marjon Main-Roetgerink

design team  
Arthur Loomans, Eline Keus,  
Evelien van Beek, Janina Stemler,  
Joost Smorenburg, Paul Fouchier,  
Paul Vlaar, Priet Jokhan,  
Sandrine Rointru

Project team  
general contractor  
Niersman Bouw Haaglanden

acoustics consultant  
BURO Bouwfysica

structural engineer  
SWINN

services engineer  
Spindler

fire safety consultant  
ZRI

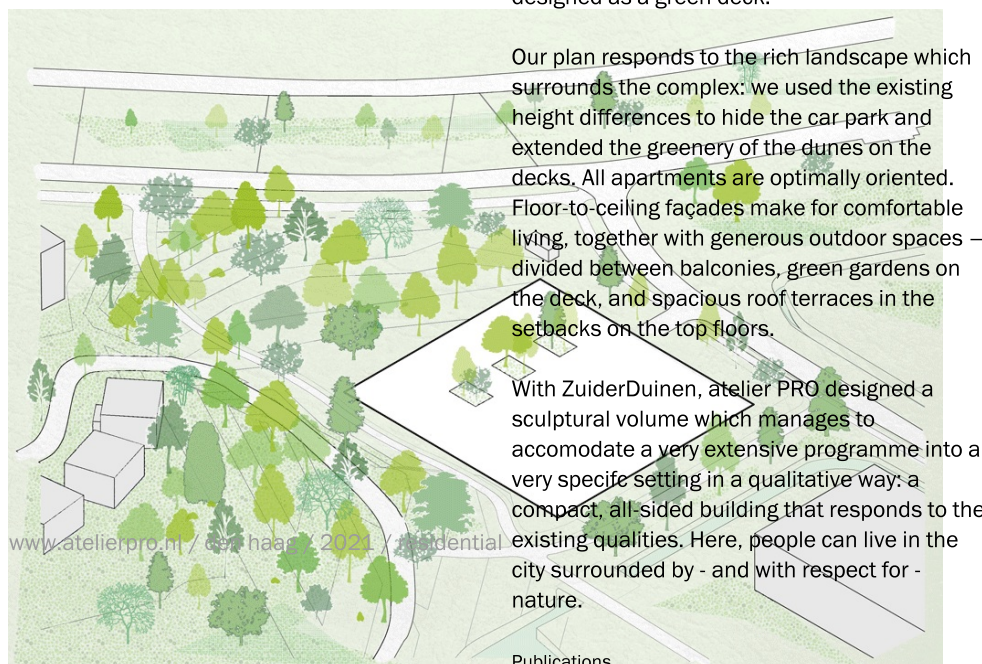

Our plan responds to the rich landscape which surrounds the complex: we used the existing height differences to hide the car park and extended the greenery of the dunes on the decks. All apartments are optimally oriented. Floor-to-ceiling façades make for comfortable living, together with generous outdoor spaces – divided between balconies, green gardens on the deck, and spacious roof terraces in the setbacks on the top floors.

With ZuiderDuinen, atelier PRO designed a sculptural volume which manages to accommodate a very extensive programme into a very specific setting in a qualitative way: a compact, all-sided building that responds to the existing qualities. Here, people can live in the city surrounded by - and with respect for - nature.

Publications  
Archello

